

DET	QTY	DESCRIPTION	LENGTH	TOT LG
1	1	RMS008-MV (FRAME)	----	----
2	1	RMS009-MV (TILT)	----	----
3	1	RMS010-MV (WEIGHT ROD)	----	----
4	1	RMS005-MV (WEIGHT)	----	----
5	1	KEY (ACTIVATION)	----	----
6	4	3/8-16UNC X 1" EYELET	----	----
7	1	5/8-11UNC X 2 BOLT	----	----
8	1	5/8-11UNC LOCK NUT	----	----
9	2	3/8-16UNC X 1-1/2 BOLT	----	----
10	6	3/8 PLAIN WASHER	----	----
11	5	3/8-16UNC LOCK NUT	----	----
12	1	3/8 LOCK WASHER	----	----
13	1	3/8-16UNC X 5" EYELET	----	----
14	1	CHAIN	----	----
15	3	5/32 HITCH PIN	----	----
16	1	RMS012-MV WEIGHT	----	----

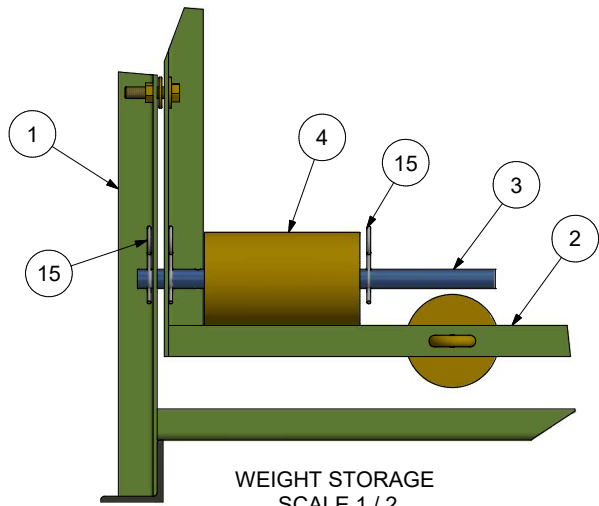
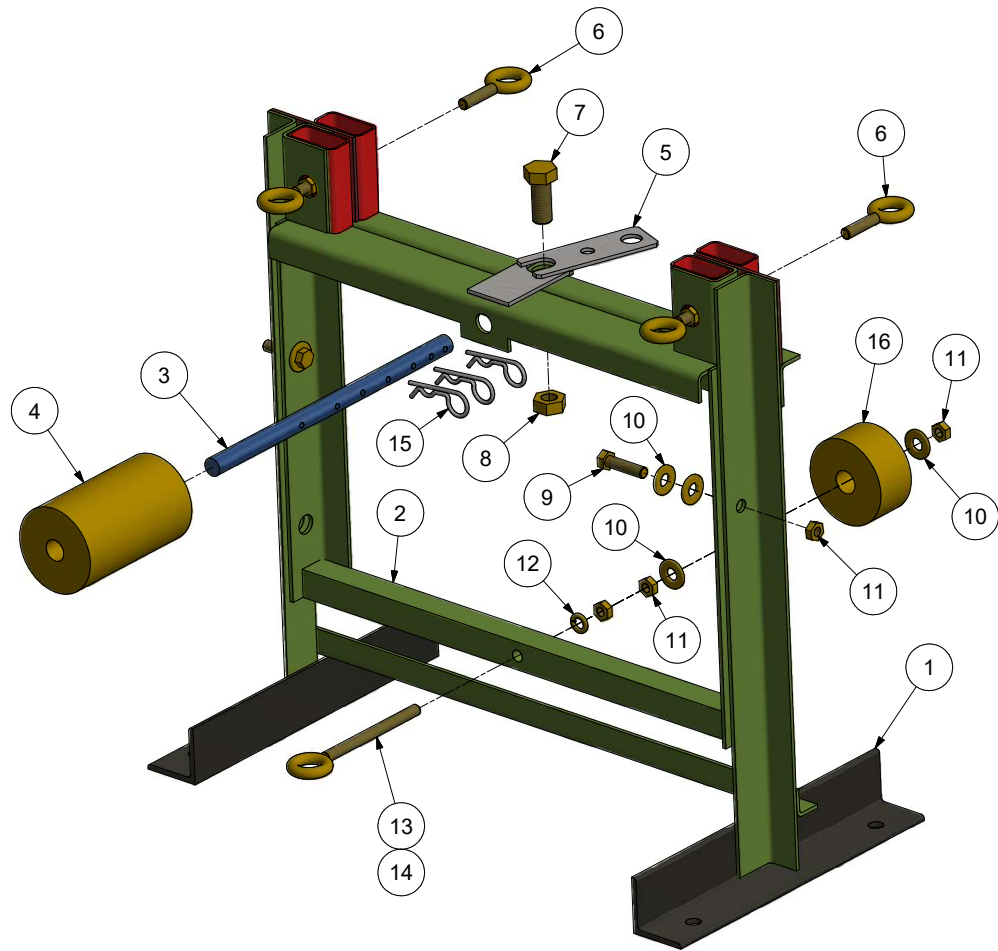

WEIGHT STORAGE
SCALE 1 / 2

CONFIDENTIAL - THE INFORMATION CONTAINED IN THIS DOCUMENT IS THE PROPERTY OF RANGE MASTER STEEL. IT IS NOT FOR PUBLIC DISCLOSURE. POSSESSION OF THIS INFORMATION DOES NOT CONVEY THE RIGHT TO LOAN, SELL OR DISCLOSE THIS INFORMATION. UNAUTHORIZED REPRODUCTION OR USE OF THIS INFORMATION IS PROHIBITED. THIS DOCUMENT IS TO BE RETURNED TO RANGE MASTER UPON COMPLETION OF THE PURPOSE FOR WHICH IT WAS LOANED OR UPON REQUEST.

HEAT TREATMENT		ENG. REF:	
HIRST DESIGN & ENG.		TITLE ASSEMBLY DRAWING	
MAX TRAP ASSEMBLY			
DWN BY RBH 1/17/2017	DRG. NO.	REV. A	
CHKD BY RH 1/17/2017	SCALE 1/2	RMS003-MV-ASM	SHEET 1 OF 1